

XBOX 360 ADAPTER

FOR ARCADE STATION™ AND QUASICADE™ ARCADE MACHINES AND CONTROLLERS

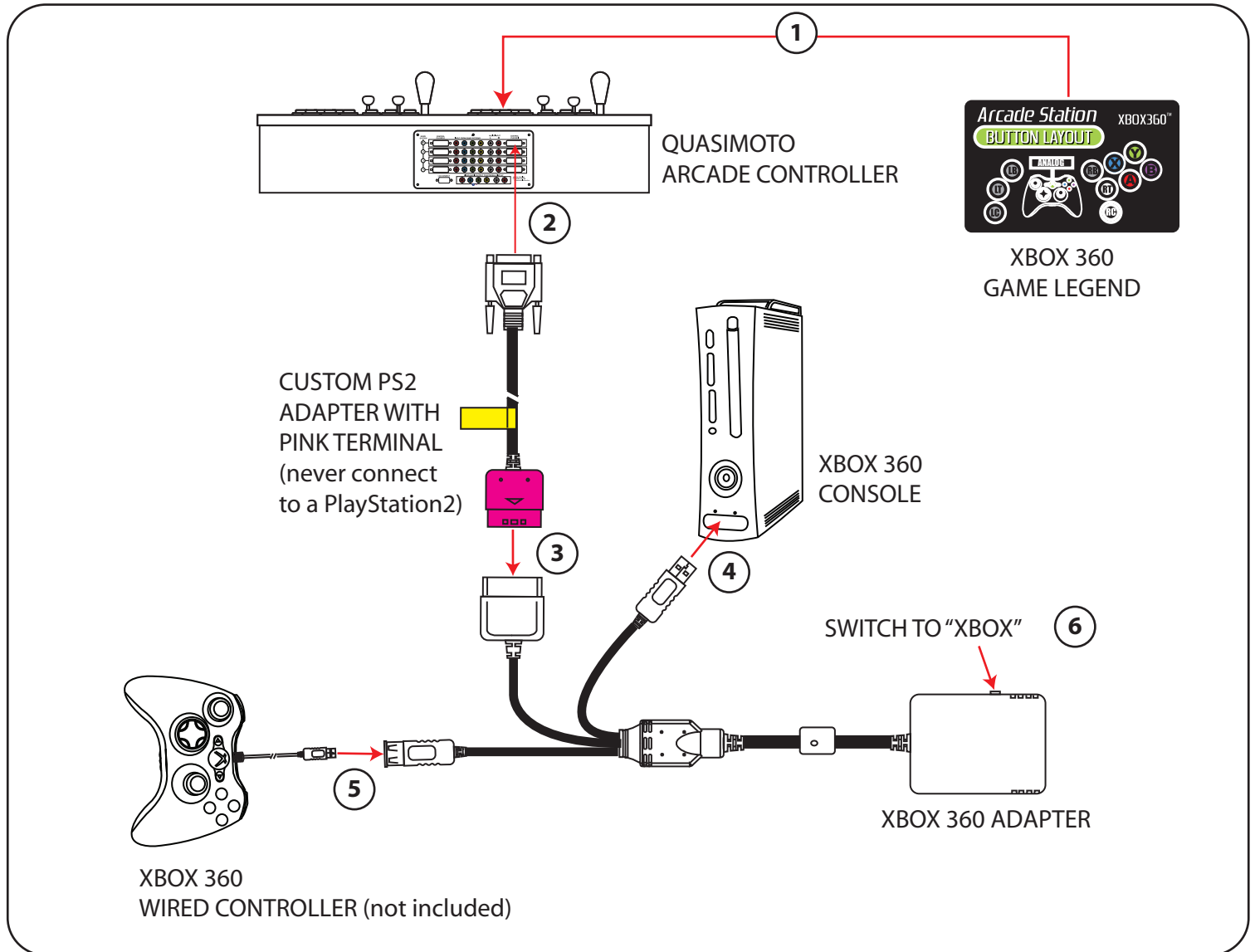

Instructions:

1. Insert the Xbox 360 legend card into the backlit legend slot on the arcade controller.
2. Connect the pink ended adapter cable to the arcade controller in the desired arcade controller port.
3. Connect the pink end into the mating connector on the Xbox 360 adapter.
4. Connect the male USB end into an available USB port on the Xbox 360 game console.
5. Connect a wired Xbox 360 controller to the female USB port on the Xbox 360 adapter.
6. Make sure the Xbox 360 adapter is switched to "XBOX".
7. If two players are desired, repeat these steps for the second player with a second Xbox 360 adapter.
8. Set the controller to the correct input (Arcade Station only) and power on the Xbox 360 console.
9. TIP: if your arcade controller has an Analog button (on the front of the Arcade Station controller), this will function as the Guide button for the Xbox 360 game console.

QUESTIONS? CALL TOLL FREE 888-400-5774